

THIS DRAWING UNPUBLISHED.

RELEASED FOR PUBLICATION

LOC		DIST		REVISIONS			DATE	DWN	APVD
P	LTR								
-	-	-	-	-	-	-	-	-	

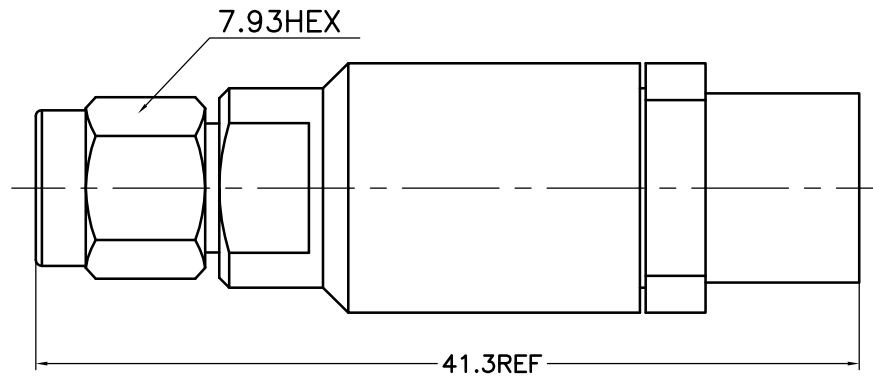

NOTES:

1.ELECTRICAL:

- 1.1 IMPEDANCE: 50Ω
- 1.2 INSULATION RESISTANCE:5000MΩ MIN
- 1.3 FREQUENCY RANGE: DC~18GHz
- 1.4 DIELECTRIC WITHSTANDING VOLTAGE: 1000V MAX AT SEA LEVEL
- 1.5 VSWR≤1.20:1@18GHz
- 1.6 INSERTION LOSS: 0.05√FREQUENCY

2.ENVIRONMENTAL:

TEMPERATURE RANGE: -55° to +165°

3.MATERIAL AND FINISH:

BODY: STAINLESS STEEL TYPE 303, PASSIVATE
 NUT: STAINLESS STEEL TYPE 303, PASSIVATE
 CENTER CONTACT: BRASS, GOLD PLATING
 DIELECTRIC: PTFE, N/A

THIS DRAWING IS A CONTROLLED DOCUMENT.		DWN	DWP	15/07/2008	Micable Inc.		
DIMENSIONS MM		CHK					
TOLERANCES UNLESS OTHERWISE SPECIFIED:		APVD			SIZE	CAGE CODE	DRAWING NO
0 PLC ±0.25		PRODUCT SPEC			A3	00779	20080001D
1 PLC ±0.15		APPLICATION SPEC			SCALE 4: 1 SHEET 1 OF 1 RVE 1		
2 PLC ±0.12		WEIGHT			CUSTOMER DRAWING		
3 PLC ±							
4 PLC ±							
ANGLES ±1°							
MATERIAL SEE TABLE							
FINISH SEE TABLE							